



5 Lodge Close

Cayton, Scarborough, YO11 3RR

Guide Price £190,000



We are delighted to bring to the market this 3 bedroom semi-detached dormer bungalow in the popular village of Cayton. In need of some modernisation this light and bright property is tucked away on a cul-de-sac. The property benefits from all the many amenities Cayton has to offer, from shops, pubs, restaurants, local transport links and sports facilities close by. When briefly described the property comprises kitchen, lounge/diner, downstairs bedroom, understairs storage and sun room. Upstairs there are two bedrooms and two shower rooms. With off road parking, garage and gardens to front and rear, the property also benefits from gas boiler and UPVC windows. Sold with NO ONWARD CHAIN, we highly recommend an early viewing of this property.



Hallway

The property is entered by a UPVC door to the side of the house which leads into a good sized hallway with doors leading off into the sitting room / diner and understairs storage cupboard. Stairs lead up to the first floor landing.

Kitchen 11'3" x 8'0" (3.43m x 2.44m)

Located at the rear of the property with vinyl flooring, wall and base units, composite work tops, built in electric double oven, part tiled walls, single stainless steel sink and drainer, breakfast bar, radiator and double glazed UPVC window overlooking the rear garden. The kitchen is accessed from the dining area at the back of the lounge via an archway.

Sitting Room / Dining Room 28'6" x 11'0" (8.69m x 3.35m)

A large room spanning the full length of the house from the front to the back. At present it is partially subdivided by a stone dividing wall with a glass top. The room is fully carpeted with a stone fireplace in the area which may most likely be used as a lounge. There is a large UPVC double glazed window to the front of the property.

Bedroom 3 14'0" x 10'3" (4.27m x 3.12m)

Located on the ground floor this room has a carpet, radiator and a UPVC double glazed window to the front of the house.

Storage/ Under stairs cupboard 5'9" x 6'6" (1.75m x 1.98m)

A large understairs cupboard which contains the meters and fuse board for the house.

Sun Room 12'6" x 7'0" (3.81m x 2.13m)

Accessed from the dining room section of the lounge the sun room is fully UPVC double glazed with electrics, plumbing and ventilation for a washing machine and tumble dryer. There are steps down into the garden which are made safe with a wooden gate. The garden is accessed via UPVC double glazed door.

Bedroom 1 17'9" x 11'0" (5.41m x 3.35m)

A large master bedroom at the front of the house with a large UPVC double glazed window. There is a radiator, carpet and built in cupboards one of which contains the Worcester Bosch boiler.

Bedroom 2 11' x 6'9" max (3.35m x 2.06m max)

A smaller second bedroom with a single glazed velux style window, carpet and radiator.

Walk in Shower 5'3" x 7'6" (1.60m x 2.29m)

A separate walk in shower located in a small room with carpet, radiator and UPVC double glazed window. The shower cubicle is tiled with a Mira Sport electric shower.

Family Shower Room 10'3" x 5'6" (3.12m x 1.68m)

A larger shower room with a generously sized shower cubicle with a Mira Admiral electric shower. There is a back to wall W.C and a handwash basin in a vanity unit. The walls are partially tiled, The floor is non slip vinyl and there is a heated towel rail.

Garage

There is a single up and over door garage at the end of the driveway with a UPVC access door to the side and a UPVC double glazed window.

Outside

There is a concrete driveway leading up to the house and garage which provides off road parking. The front garden is mainly laid to lawn with some shrubs and roses. There is a high gate leading into the fully enclosed back garden which again is laid mostly to lawn with hedges and some small flower beds.

What Three Words Location

Successes.browser.detective

Area Map



Energy Efficiency Rating

	Current	Potential
Very energy efficient - lower running costs		
(92 plus) A		
(81-91) B		81
(69-80) C	65	
(55-68) D		
(39-54) E		
(21-38) F		
(1-20) G		
Not energy efficient - higher running costs		
England & Wales	EU Directive 2002/91/EC	

Council Tax Band: C

Tenure: Freehold

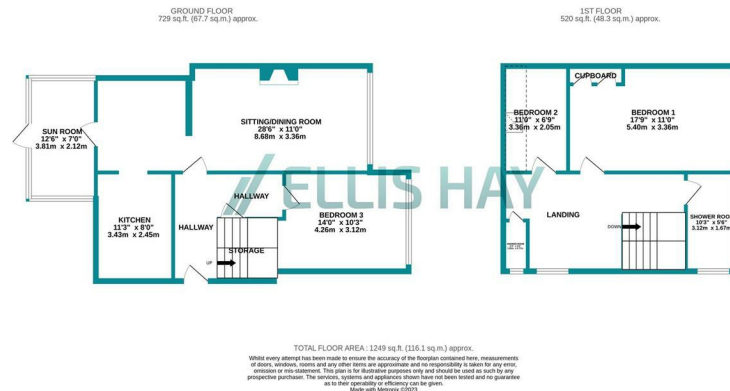

TOTAL FLOOR AREA: 1,249 sq.ft. (116.1 sq.m) approx.
 Whilst every effort has been made to ensure the accuracy of the description contained here, measurements of doors, windows, rooms and any other items are approximate and no responsibility is taken for any error, omission or mis-statement. This plan is for illustrative purposes only and should be used as a guide for any prospective purchaser. The services, systems and appliances shown have not been tested and no guarantee as to their operation or efficiency can be given.
 Made with Metropix 10/23

Ellis Hay for themselves, for any joint agents and for the vendors or lessors of this property whose agents they are, give notice that {all the particulars are set out as a general outline only for the guidance of intending purchasers or lessees, and do not constitute, nor constitute part of, an offer or contract; (ii) all descriptions, dimensions, references to condition and necessary permissions for use and occupation, and other details are given in good faith and are believed to be correct but any Intending purchasers or tenants should not rely on them as statements or representations of fact but must satisfy themselves by inspection or otherwise as to the correctness of each of them; (iii) no person in the employment of Ellis Hay, has any authority to make or give any representation or warranty whatever in relation to this property