



35 Murchison Street, YO12 7RN Guide Price £140,000

Ellis Hay are delighted to bring to the market this three-bedroomed terraced house, located on Murchison Street. In our opinion, the property offers comfortable and well-proportioned living in a convenient Scarborough location.

In our opinion the property comprises a welcoming lounge, a spacious dining room, a kitchen, and a family bathroom. Upstairs, there are three good-sized bedrooms, making this home ideal for families or first-time buyers alike.

Externally, the property benefits from a private rear yard, perfect for outdoor seating or low-maintenance entertaining.

Situated close to local shops, schools, public transport links, Scarborough's town centre, seafront, and a range of restaurants, in our opinion, the property offers a combination of practicality and charm.

Early viewing is highly recommended to appreciate the space and location on offer.

Please call our friendly sales team on 01723 350077 to arrange a viewing.

35 Murchison Street

Ellis Hay are delighted to bring to the market this three-bedroomed terraced house, located on Murchison Street. The property offers comfortable and well-proportioned living in a convenient Scarborough location.

In our opinion the property comprises a welcoming lounge, a spacious dining room, a kitchen, and a family bathroom. Upstairs, there are three good-sized bedrooms, making this home ideal for families or first-time buyers alike.

Externally, the property benefits from a private rear yard, perfect for outdoor seating or low-maintenance entertaining.

Situated close to local shops, schools, public transport links, Scarborough's town centre, seafront, and a range of restaurants, in our opinion, the property offers a combination of practicality and charm.

Early viewing is highly recommended to appreciate the space and location on offer.

Please call our friendly sales team on 01723 350077 to arrange a viewing.

Lounge 16'4" x 15'3" (5.00 x 4.67)

Dining Room 19'6" x 13'9" (5.96 x 4.20)

Kitchen 10'2" x 7'7" (3.12 x 2.32)

Bedroom 1 19'6" x 14'10" (5.96 x 4.53)

Bedroom 2 19'6" x 9'11" (5.96 x 3.04)

Bedroom 3 11'8" x 11'7" (3.56 x 3.54)

Bathroom 11'8" x 7'11" (3.56 x 2.42)

Directions

What 3 words
Stage.rival.heat

Floor Plan

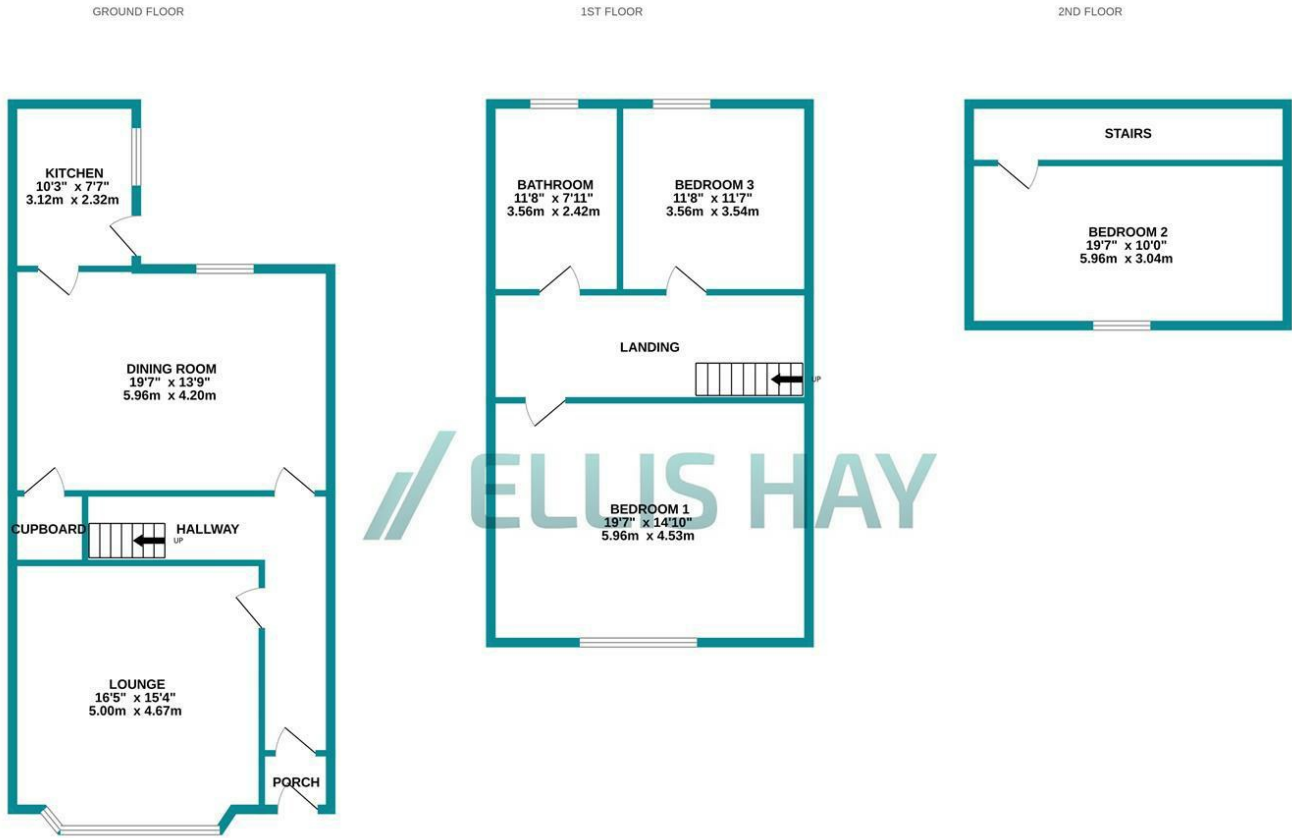

Whilst every attempt has been made to ensure the accuracy of the floorplan contained here, measurements of doors, windows, rooms and any other items are approximate and no responsibility is taken for any error, omission or mis-statement. This plan is for illustrative purposes only and should be used as such by any prospective purchaser. The services, systems and appliances shown have not been tested and no guarantee as to their operability or efficiency can be given.
Made with Metropix ©2025

Area Map

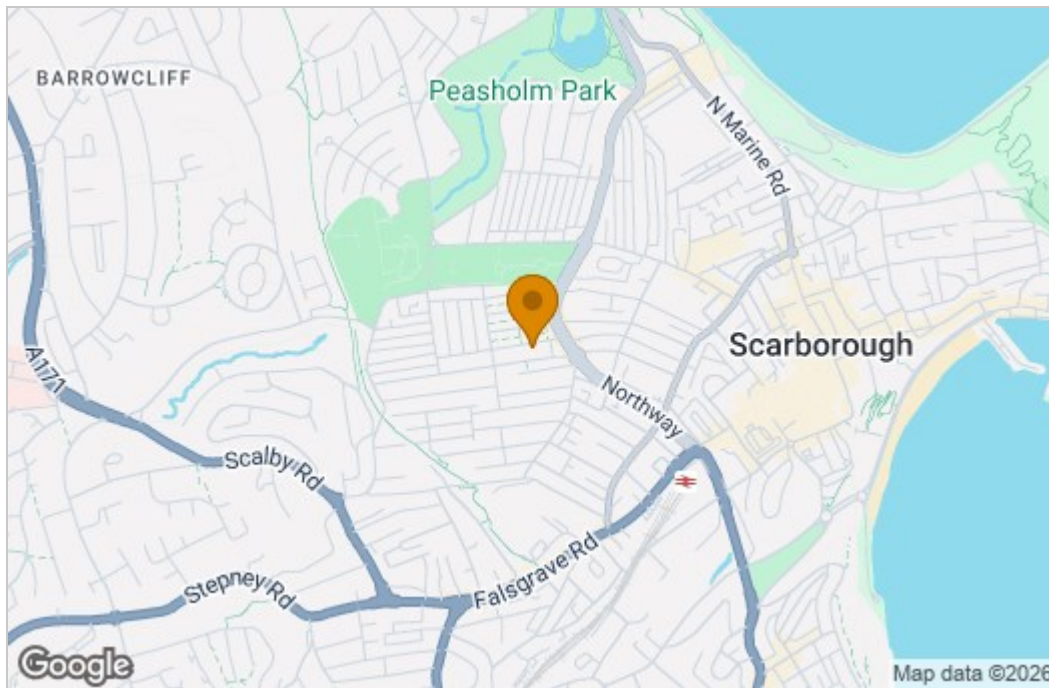

Energy Efficiency

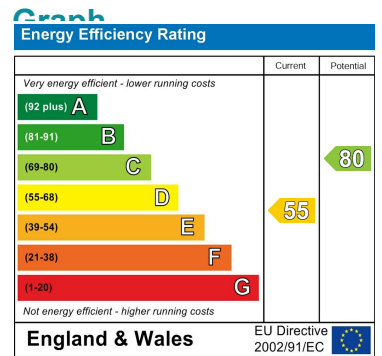

These particulars, whilst believed to be accurate are set out as a general outline only for guidance and do not constitute any part of an offer or contract. Intending purchasers should not rely on them as statements of representation of fact, but must satisfy themselves by inspection or otherwise as to their accuracy. No person in this firm's employment has the authority to make or give any representation or warranty in respect of the property.